



## KPP-06

SET OF ADDITIONAL ACCESSORIES FOR ORTHOPEDICS AND TRAUMATOLOGY SURGERIES (FOR PLASTER BANDAGING IN PELVIC ZONE AND LOWER LIMBS)



LEARN MORE

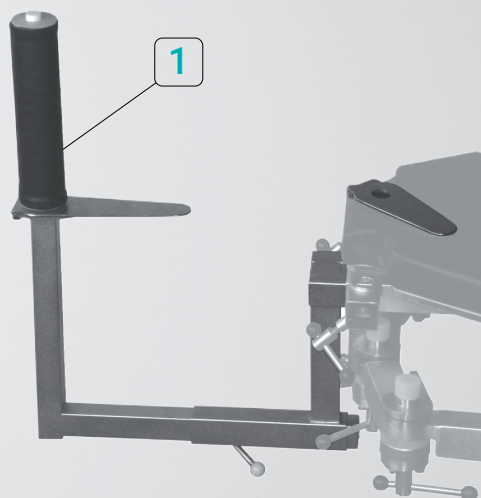

Addition to the basic set.

Used with KPP-02 set only

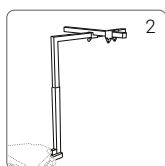
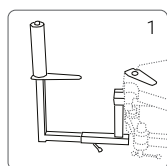
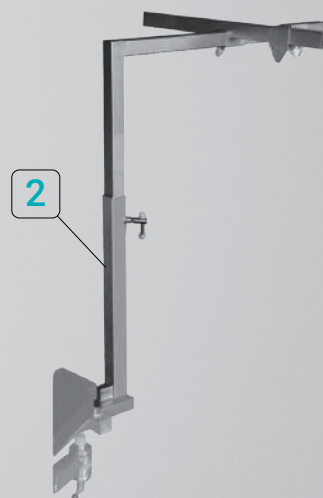

KPP-06 set includes the following:

1. Assembly for plaster bandaging in pelvic zone
2. Cross bar stand for leg suspending

1 pc.

1 pc.

